

ARCATE LATERALI IN TAGLIA DELTA Y CAR FRAMES FOR TACKLE PISTON - TYPE DELTA Y

ottobre_2008

DIAGRAMMA DI UTILIZZO
USE DIAGRAM

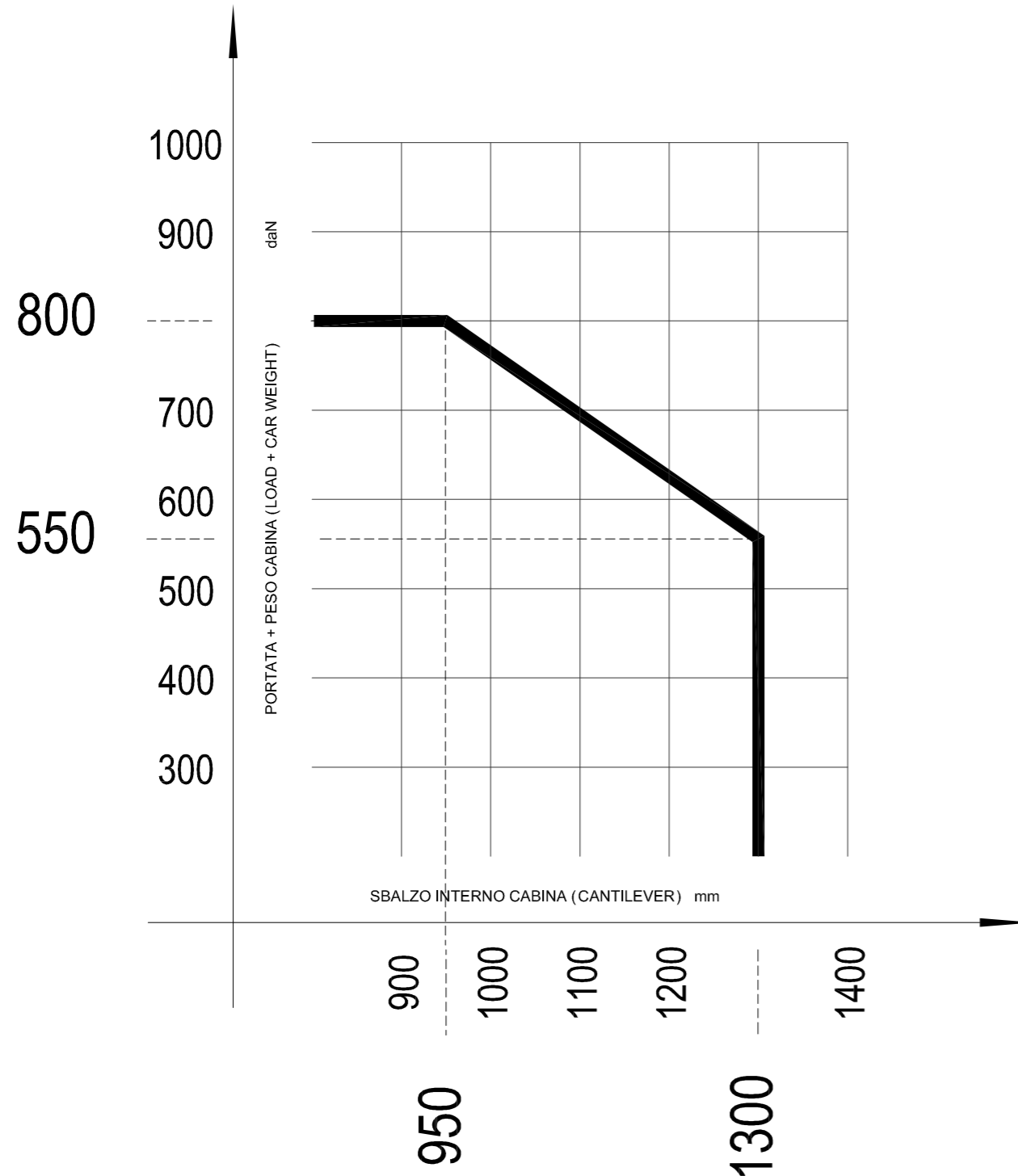

| | | | | | | | | |
|--|-------------------|---|--|---|--------------------|----------------------------------|----------------------|-------------------------|
| | Delta Y | <input type="checkbox"/> ORDINE (ORDER) <input type="checkbox"/> RICH. OFFERTA(OFFER REQUEST) | INFORMAZIONI AD USO INTERNO PRIMAFASE CTR | | | | | |
| DATI CLIENTE (CUSTOMER DETAILS) RAGIONE SOCIALE (COMPANY NAME): INDIRIZZO (ADDRESS): CAP (ZIP CODE): P.IVA (VAT No.): TEL: FAX: E-MAIL: | | DATI IMPIANTO cliente (customer SYSTEM DETAILS) RIFERIMENTO ORDINE (ORDER REFERENCE): DATA ORDINE (ORDER DATE): CONSEGNA RICHIESTA (DELIVERY DATE REQUESTED): LUOGO DI CONSEGNA (DELIVERY LOCATION): | | | | | | |
| ARCATA CON ACCESSORI (CAR FRAME WITH ACCESSORIES) | | | | | | | | |
| <input type="checkbox"/> ARCATE DELTA Y - SCT 400 Q.TA: (DELTA Y CAR FRAMES - SCT 400) | | LUNGHEZZA PILASTRO PISTONE: (PILLAR LENGTH) | | | | | | |
| <input type="checkbox"/> COLLARE SUPPLEMENTARE Q.TA: (ADDITIONAL COLLAR) | | <input type="checkbox"/> STD 3000 mm <input type="checkbox"/> L: 3300 mm <input type="checkbox"/> L: | | | | | | |
| <input type="checkbox"/> VERNICIATURA RAL COD. RAL: (RAL PAINTWORK COD. RAL) | | | | | | | | |
| SELEZIONARE IL TIPO DI AMMORTIZZATORE (SELECT TYPE OF SPRING BUFFER) | | | | | | | | |
| | CAMPO (FIELD) (N) | TIPO (TYPE) | Ø FILO (WIRE Ø) (mm) | Ø MEDIO (AVERAGE Ø) (mm) | PASSO (PITCH) (mm) | SPIRE ATTIVE (ACTIVE TURNS) (N°) | FRECCIA (ARROW) (mm) | LUNGHEZZA (LENGTH) (mm) |
| <input type="checkbox"/> | 4630 / 7350 | 02 / A | 14 | 71 | 24 | 9 | 77.4 | 230 |
| <input type="checkbox"/> | 6300 / 10000 | 02 / B | 15 | 70 | 25 | 9 | 76.5 | 240 |
| <input type="checkbox"/> | 9950 / 15800 | 02 / C | 18 | 84 | 31 | 7 | 78.4 | 235 |
| | | | | E = 80000 N / mm ² V MAX = 0,7 m/s | | | | |
| CARICO SOSPESO E MINIMO PER UNA COPPIA DI MOLLE (SUSPENDED AND MINIMUM LOAD FOR A PAIR OF SPRINGS) | | | | | | | | |
| | | | | | | | | |
| STAFFAGGI (BRACKETS) | | | | | | | | |
| <input type="checkbox"/> Q.TA COPPIE: (NUMBER OF COUPLES) | | | | <input type="checkbox"/> TIPO A x min = 125 x max = 210 | | | | |
| | | | | <input type="checkbox"/> TIPO B x min = 220 x max = 310 | | | | |
| | | | | | | | | |
| GUIDE (GUIDES) | | | | | | | | |
| <input type="checkbox"/> T70 - 2A (70 X 70 X 8) | | | | | | | | |
| <input type="checkbox"/> T82 / A (82,5 X 68,25 X 9) | | | | | | | | |
| | | | | H COLONNA (mm) = Fossa + Corsa + Testata - 50 = (Calcolo consigliato) TOTAL HEIGHT (mm) = Pit + Travel + Headroom - 50 (Recommended calculation) | | | | |
| FUNI (ROPES) | | | | | | | | |
| <input type="checkbox"/> FORNITE (SUPPLIES) | | | | LUNGHEZZA ROTOLI (mm) = Fossa + Corsa + (Testata x 2) (4 ROTOLI - D = 6,5 -114 + 1anlma -1770) | | | | |
| <input type="checkbox"/> Mt. | | | | ROLL LENGTH (mm) = Pit + Travel + (Headroom x 2) (4 ROLL - D = 6,5 -114 + 1soul -1770) | | | | |
| OLIO (OIL) | | | | | | | | |
| <input type="checkbox"/> FORNITO (SUPPLIED) | | | | FUSTI DA 18 Kg (q.ta) = (fluido minerale) 18Kg BARRELS (q.ta) (mineral fluids) | | | | |
| NOTE (NOTES) | | | | TIMBRO E FIRMA (STAMP AND SIGNATURE) | | | | |
| | | | | | | | | |

CARATTERISTICHE TECNICHE
SPECIFICATIONS

| | | | |
|--------------------|--------------------------|-------------|-----|
| S (D.T.G) | S (D.B.G) | 400 | mm |
| PESO ARCATA | CAR SLING WEIGHT | 120 | daN |
| FUNI | CABLES | 4 | n |
| DIAMETRO FUNI | MAX. CABLE DIAMETER | 6.5 * | mm |
| DIAMETRO PULEGGIA | MAX. PULLERY DIAMETER | 265 DOPPIA | mm |
| PESO ARCATINA | REDUCED CAR SLING WEIGHT | 30 | daN |
| PILASTRINO | SUPPORT | 80 X 80 X 4 | mm |
| DIAMETRO** PISTONE | MAX. JACK** DIAMETER | MAX. 90 | mm |

** UTILIZZARE SOLO PISTONE COMPACT (HYDRONIC LIFT)

* ONLY FOR PISTON TYPE COMPACT (HYDRONIC LIFT)

* CERTEX - DRAKO CERTIFICATE TUV

E' CONSIGLIATO L'UTILIZZO DI UNA TERZA GUIDA

IT IS ADVICE THE USE OF AN ADDITIONAL GUIDE

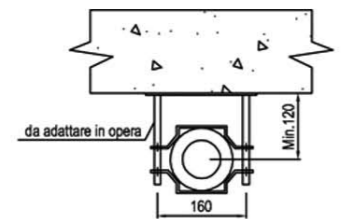
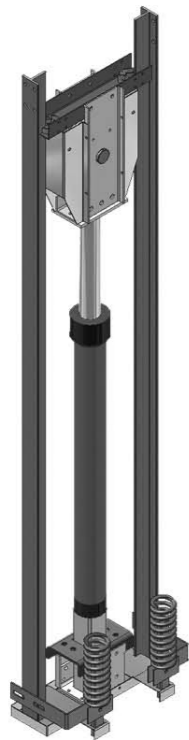

ATTACCO PISTONE
CYLINDER BRACKET

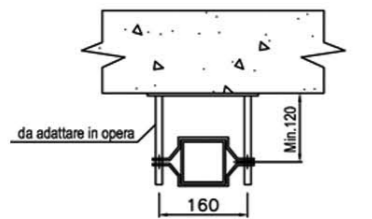

ATTACCO PILASTRINO
PIT ROPE ATTACHMENT

| CAMPO | TIPO | Ø FILO | Ø MEDIO | PASSO | SPIRE ATTIVE | FRECCIA | L. |
|--------------|--------|--------|-----------|-------|--------------|---------|-----|
| FIELD | TYPE | Ø WIRE | Ø AVERAGE | PITCH | ACTIVE TURNS | ARROW | L. |
| 4630 / 7350 | 02 / A | 14 | 71 | 24 | 9 | 77.4 | 230 |
| 6300 / 10000 | 02 / B | 15 | 70 | 25 | 9 | 76.5 | 240 |
| N | | mm | mm | mm | N° | mm | mm |

E = 80000 N / mm² V MAX = 0.7 m / s

CARICO SOSPESO MASSIMO E MINIMO PER UNA COPPIA DI MOLLE

MAX. AND MIN. LOAD FOR A PAIR OF SPRINGS

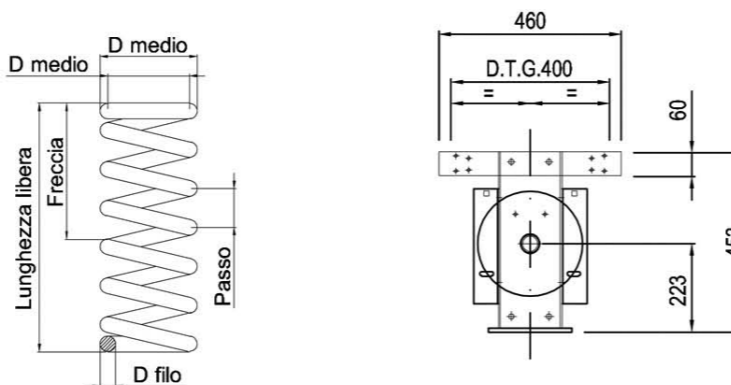
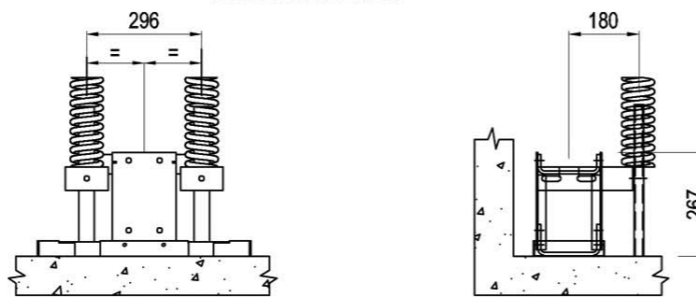
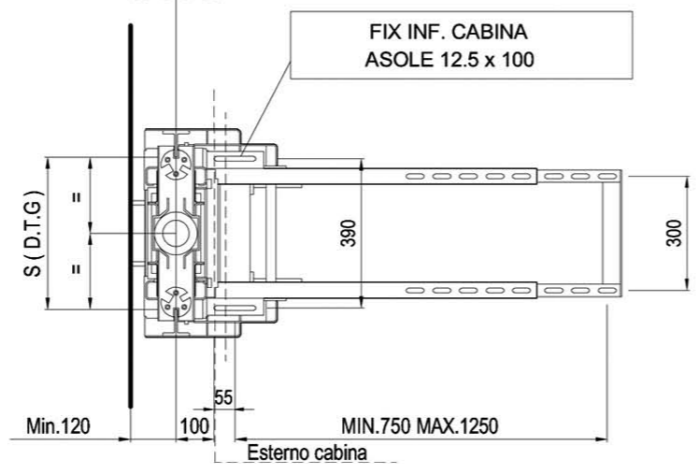
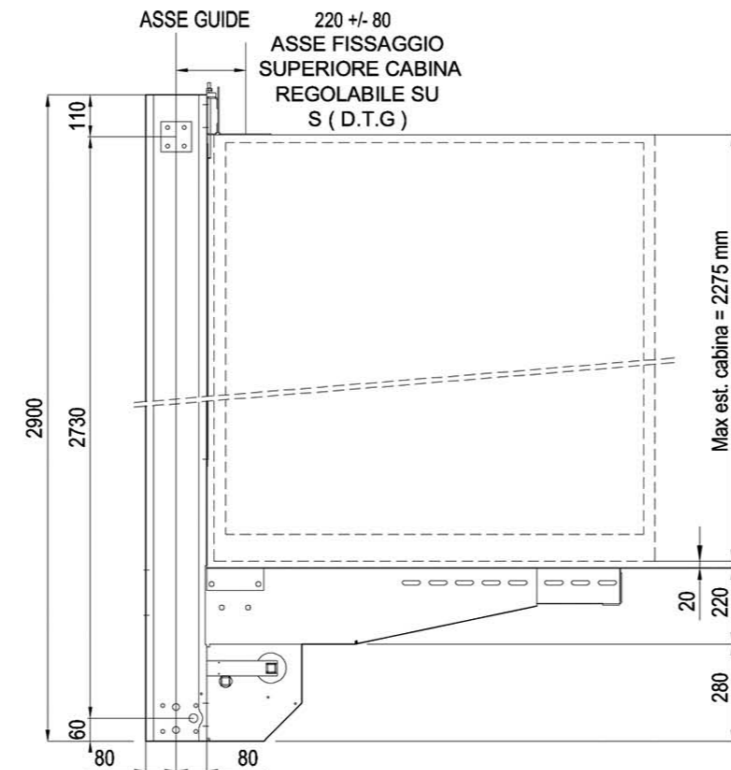

FORNITURA E COMPLETAMENTO DELLA PARTE MECCANICA
COMPLETE SUPPLY OF MECHANICAL PARTS

MATERIALI COMPRESI NELLA FORNITURA INCLUDED IN THE SUPPLY

- STAFFE GUIDA
- CONTROSTAFFE ZINcate BIANCO
- BULLONERIA DI FISSAGGIO (ESCLUSI TASSELLI)
- GUIDE BRACKETS
- ZINC-PLATING BRACKETS
- BOLTS AND NUTS (NOT INCLUDED SCREWS)

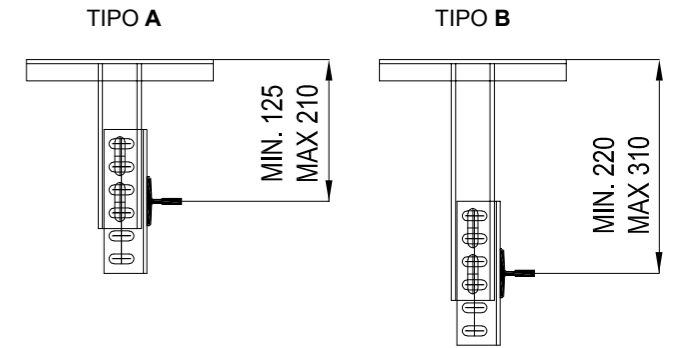

STAFFE GUIDA GUIDE BRACKETS

MATERIALI COMPRESI NELLA FORNITURA INCLUDED IN THE SUPPLY

- N. 2 COLONNE GUIDA TRAFILATE IN BARRE DA 5 METRI + SPEZZONI TAGLIATI A MISURA
- PIASTRE DI GIUNZIONE COMPLETE DI BULLONERIA
- N. 2 GUIDE (5 METRE BARS) + CUT-DOWN SIZE
- JOINT PLATES + BOLTS AND NUTS

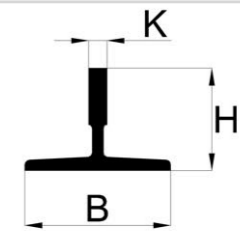

| TIPO | B | H | K |
|-------|------|-------|---|
| T70 A | 70 | 70 | 8 |
| T82 A | 82.5 | 68.25 | 9 |

GUIDE GUIDES

MATERIALI COMPRESI NELLA FORNITURA INCLUDED IN THE SUPPLY

- N. 4 ROTOLI DI FUNE Ø = 6,5 mm TAGLIATE A MISURA
- COMPOSIZIONE FUNE: 6 TREFOLI - 114 FILI
- DOPPIA CLASSE DI RESISTENZA: 1770 N\mmq
- CARICO DI ROTTURA: 31,5 KN
- MASSA: 17,90 Kg\100 m
- AREA METALLICA: 21,4 mmq
- N. 4 ROPE ROLLS Ø = 6,5 mm CUT TO SIZE
- ROPE COMPOSITION: 6 STRANDS - 114 WIRES
- DOUBLE CLASS RESISTANCE: 1370 - 1770 N\mmq
- BREAKING LOAD: 31,5 KN
- MASS: 17,90 Kg\100 m
- METAL AREA: 21,4 mm²

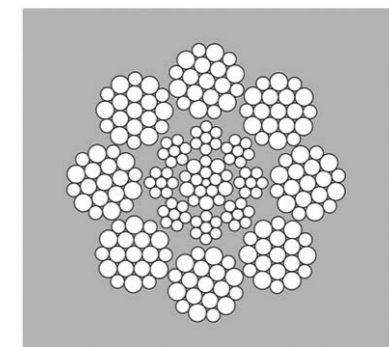

FUNI ROPES

MATERIALI COMPRESI NELLA FORNITURA INCLUDED IN THE SUPPLY

- FLUIDO IDRAULICO MINERALE in secchi da 18 kg. (circa 21 Litri)
- MINERAL HYDRAULIC FLUID in 18Kg buckets.(approx. 21 litres)

OLIO IDRAULICO HYDRAULIC OIL